



Falcon 65T forward arm

The new Bomford Falcon 6.5T has been designed with a stronger, more compact mainframe. Utilising the tried and tested 125 litre independent hydraulic system, producing 65hp at the head, the Falcon is popular with both the agricultural and local authority contractors. Available in parallel or non-parallel, three-point linkage mounted using the Bomford quick hitch system or axle bracket mounted, this robust and modern machine is perfectly suited to the professional operator. The new 6.5m reach is achieved via a telescopic arm and is controlled by the compact and fully proportional Cable, Electronic Proportional or Intelligent control system. As with all Falcon models, the cooling system is mounted on top of the oil tank for working in the most demanding conditions. The Falcon range also offers front-mounted and forward arm options and debris blowers amongst its versatile armoury of options.

The new forward arm design brings the cutting head forward by 1.2m and inline with the driver which reduces fatigue and improves safety.



See the Falcon 6.5T FWD on stand G2

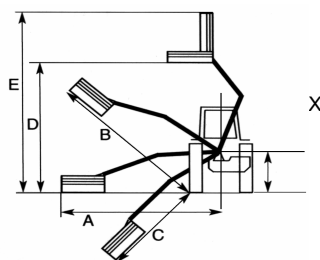

	non-par
A =	6.5m
B = 45° up bank	6.7m
C = 45° down bank	4.9m
D = pivot height 1.35m	4.4m
E = pivot height 1.35m	7.9
X =	1.4m

Falcon 6.5T & 6.5TP Specification					
Min tractor hp	80hp	Piston pump	Option	Cutting options, left & right	Option
Min tractor weight	4000kg	Cast iron gear box	Standard	Cable rotor reverse	Option
3-pt Lkg	Option	Oil tank capacity	250 litres	Electric rotor reverse(DSR)	Option
Axle bracket	Option	Oil tank capacity	66 usg	Replaceable skids	Option
Max reach	6.5m	Rear tractor mounting	Standard	Front flap	Option
Weight with oil	1550kg n/p	Arm geometry n/p	Standard	Road lights	Standard
Cable control	Option	Telescopic arm	900mm tele ext	Cowl wear bar	Option
Electric proportional control	Option	Power slew 94°	Standard	Bladed saw head	option
Intelligent control system	Option	Hydraulic breakout	Standard	Ditch cleaner	option
Hyd hp at the head	65hp	Armfloat – manual	Option	Debris blower	Option
Pump flow rate	125 l/p/m	Armfloat – electric	Option	Cab guard kit	Standard
Independent hydraulics	Standard	Headfloat – manual	Standard	Warning arrow	Option
Twin gear pump	Standard	Headfloat – electronic	Standard	Variable track bracket	Option
Flailhead - 1.2 Pro-Cut, 245° head angling cont or 1.5m. Choice of flails					

Contact Chris Tucker for photos and general information. ctucker@bomford-turner.com Tel: 01789 773383